



# KOBE S/ZZLERS

---

STEAKHOUSE

landlordpack





## OUR CONCEPT

Our motto is one word “Quality” reflected throughout the entire organisation, from the core ingredients to the staff, décor, and location.

Attention to detail in all these aspects ensure we give our customers a memorable dining experience.

The freshest Ingredients are delivered daily to ensure our meals are of the highest standard.

The quality of our British beef is carefully monitored from farm to plate, with all steak cuts matured to perfection in a dry ageing chamber for 35 days.

**KOBE S/ZZLERS**  
STEAKHOUSE





## OUR VISION

Our first restaurant opened in November 2015, being firmly established as a favourite amongst locals and people coming from far and wide, which has enabled us to grow organically to a second site in Birmingham.

In just 2 years, we are very proud to have placed a top 30 restaurant listing on TripAdvisor, out of over 1000 establishments in Leicester.

With the success enjoyed thus far, and a template based on “Quality” without compromise, our vision is to establish a network of restaurants in all major cities across the UK.

**KOBE S/ZZLERS**  
STEAKHOUSE





## OUR REQUIREMENTS

Units with A3

2500 sq ft or greater

Destination Location

Proximity to City Centre

## OUR PRIORITY LOCATIONS

Birmingham City Centre

Manchester City Centre

Leeds City Centre

London

**KOBE S/ZZLERS**  
STEAKHOUSE



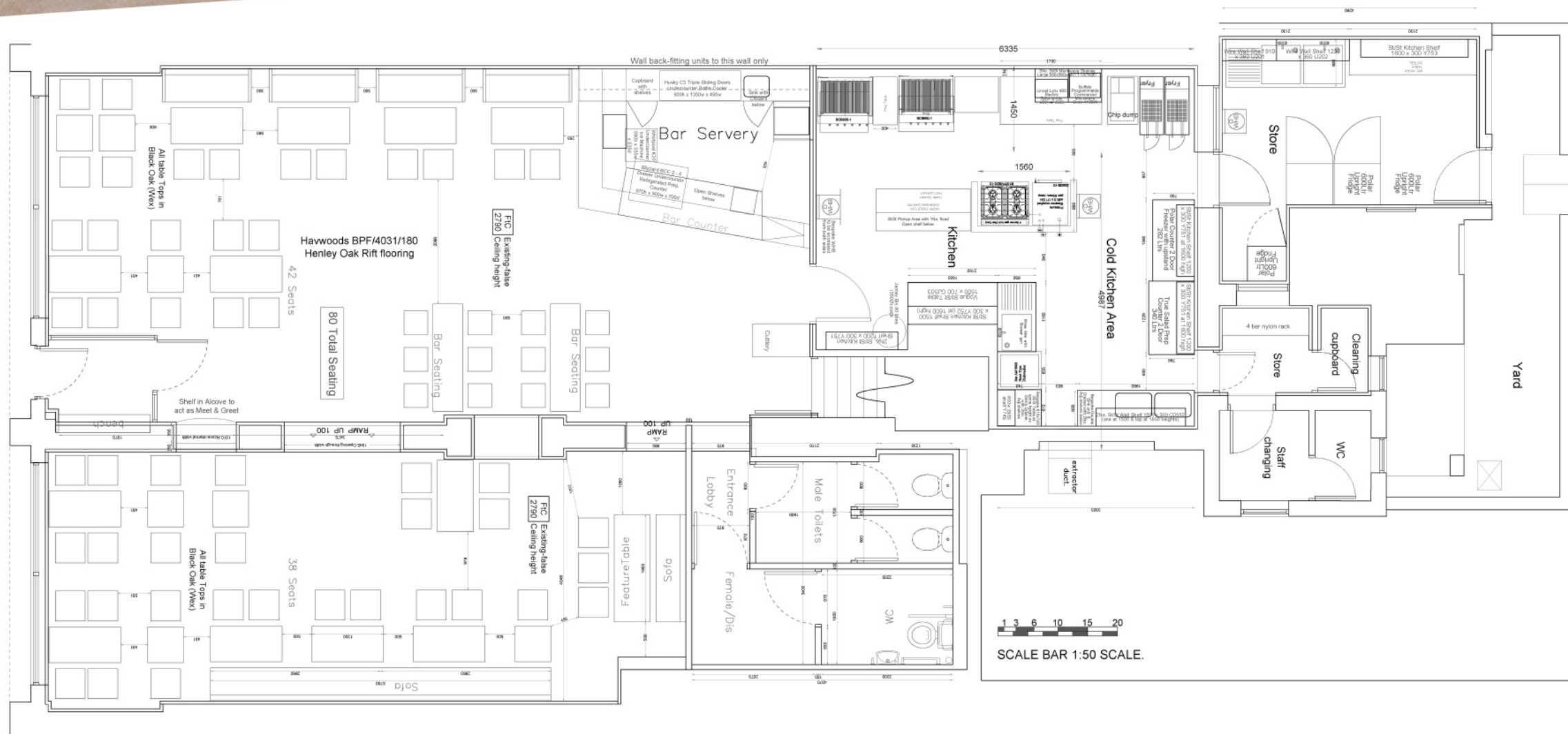

**KOBE S/ZZLERS**  
STEAKHOUSE





## OUR DETAILS

Kobe Sizzlers

a: 64-66 London Road, Leicester, LE2 0QD

t: 01162 225555

e: [Info@kobesizzlers.co.uk](mailto:Info@kobesizzlers.co.uk)

w: [www.kobesizzlers.co.uk](http://www.kobesizzlers.co.uk)

## OUR AGENTS

MBI (Surveyors) Limited

a: The Coré, Milton Hill, Abingdon, Oxon, OX13 6AB

t: 01235 828239

e: [Mattbrooks@mbiproperty.co.uk](mailto:Mattbrooks@mbiproperty.co.uk)

w: [www.mbiproperty.co.uk](http://www.mbiproperty.co.uk)

## FINANCIAL ADVISORS

Smith Hannah

a: 50 Woodgate, Leicester, LE3 5GF

t: 01162 519299

e: [Info@smithhannah.co.uk](mailto:Info@smithhannah.co.uk)

w: [www.smithhannah.co.uk](http://www.smithhannah.co.uk)

**KOBE S/ZZLERS**  
STEAKHOUSE